

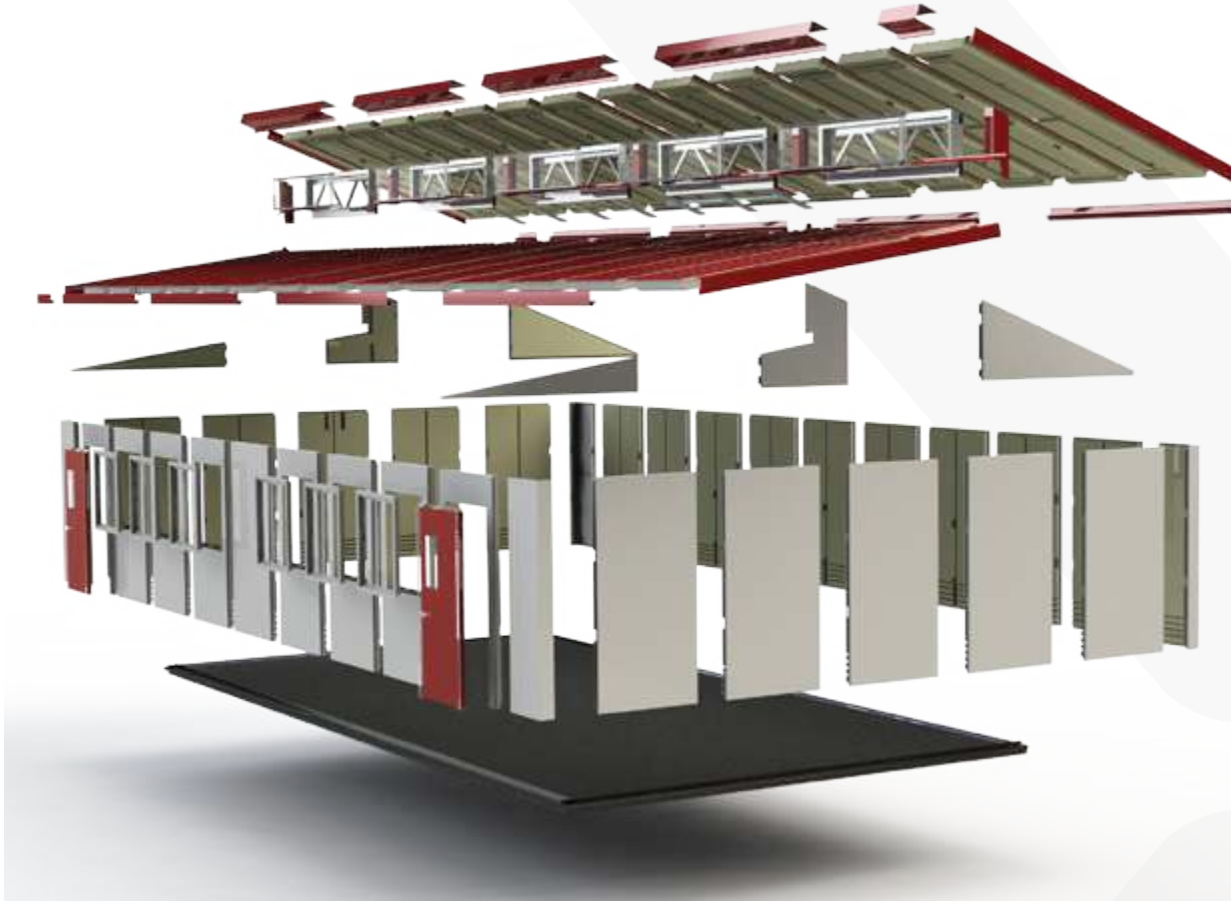

Building System

Be Proud of Your Investment

EXO™ Building System



The EXO™ Building System is a network of structural panels, designed to address the shortcomings of traditional building methods. It produces a modern, healthy and energy efficient workspace that everyone can be proud of.



EXO™ Panel

The core of our innovation is the EXO™ Panel. Its four layers include some of the top architectural materials on the market:

- Steel Tube Frame
- Rigid Closed-Cell Insulation
- Coated Steel Cladding
- Vapor Barrier

When fused together, the benefits of each are amplified to deliver superior performance.



We offer a wide range of Panels, each with a unique purpose (wall, roof, gable, door, etc.).

EXO™ Classroom Edition

The EXO™ Building System can be rearranged to generate a variety of different models. EXO™ creates an open, bright and comfortable environment that is ideal for a classroom setting.



Key features of the classroom model:

- Clerestory Roof
- Double Glazed Steel Truss
- Double Glazed Vinyl Windows
- Two Steel Doors with Windows

The interior can be configured to meet your specific requirements.

6.10SLT

Modern Architecture

A classroom should optimize learning and instill pride; however, most modular structures are boxy and uninviting. EXO™ classrooms combine a high ceiling, steel exterior and overall modern aesthetic, to make an uplifting addition to any schoolyard.



The two specialized coatings that cover our steel cladding prevent it from rusting, even if scratched.



Natural light has been linked to improved mood, alertness and productivity. Our clerestory windows capture light throughout the day and illuminate the center of the room.



Multiple options available to control and diffuse direct sunlight through clerestory windows.



Functional and engaging, this model establishes a motivating workspace that is adaptable to a variety of classroom layouts.



DOUBLE GLAZED STEEL TRUSS

Our customized steel truss is the defining feature of our EXO™ classroom model. It eradicates the need for structural posts and elevates our ceiling to make the classroom feel larger.

Healthy Environment



Air quality is a major determinant of overall health and well-being. Dampness, mold and poor ventilation trigger common ailments, such as allergies and asthma.

The EXO™ Building System has eliminated the conditions that lead to contaminated air. Our Panels are completely wood-free and their components repel moisture and mold.

In addition to our conventional heating and ventilation system, the windows in our steel truss open to permit natural ventilation. This helps to prevent stale air, particularly during warm summer months.



Airtight construction and double-glazed windows keep the dampness outside.



Steel frames and solid walls prevent pests from damaging the structure or vapour barrier.



Energy Efficient

Rigid closed-cell insulation is a high quality product that achieves greater R-values than fiberglass or polystyrene. During production it expands into all voids, eliminating air pockets and channels.

Decreases in energy consumption significantly lower operation costs. There are monthly savings on utility bills and long term savings on system maintenance.



An investment in energy efficient technology reduces the ecological footprint of a classroom and sets a positive example.



Effective insulation creates a comfortable internal climate that does not change with the whims of the season.

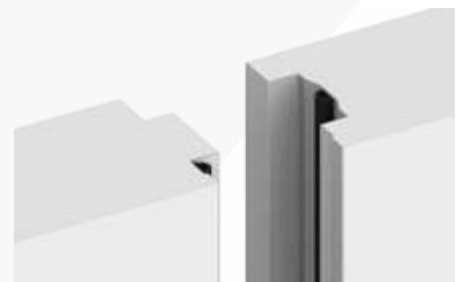

INTERLOCKING JOINTS

When our interlocking joints engage an airtight seal is created. With no leaks or drafts, temperatures remain consistent throughout the building.

EXO™ Quad Model

This 4 classroom EXO model is our newest addition, it features the benefits of an internal vaulted corridor and multiple storage/washrooms.

13.20SLT



EXO™ 2 Storey Model

The EXO 2 Storey model is now available and is a great way to maximize your long term investment by utilizing the land you have in the most efficient way.

6.30DLT



Build up instead of out.

Why choose EXO™?

The EXO™ Building System is...



... a modern, advanced, design.



... temperature controlled.



... Canadian manufactured.



... water and moisture repellent.



... bright and spacious.



... cost effective to deliver.



... air tight and draft free.



... naturally ventilated.



... ISO-9001: 2008 certified.



... pest and termite resistant.



... a sustainable solution.



... made from recyclable materials



... mold and allergen resistant.



... an energy smart solution.



... a high quality product.

And, building with EXO™...



... is quick and simple.



... requires no heavy equipment



... saves you money on labour.



... minimizes construction waste.



6.30DL



Contact

EXO™ Building System
9136 196A Street
Langley, British Columbia
Canada V1M 3B4
T. 604-888-2008

info@exobuildings.com
www.exobuildings.com



The EXO™ Building System meets the prescriptive requirements of ASHRAE 90.1 - 2010 for Part 3, 4 and 5 as required by the current British Columbia Building Code.

EXO™ Building System and the EXO™ logo are trademarks of EXO™ Building System.

Patents Pending: All building systems, construction methods, composite steel technology and innovations detailed in this document are the property of EXO™ Building System.

ALL RIGHTS RESERVED ARE PROPERTY OF EXO™ Building System.
USE OR REPRODUCTION WITHOUT PRIOR WRITTEN PERMISSION IS PROHIBITED.
BUILD ONLY FROM ISSUED CONSTRUCTION DRAWINGS.